

# PHASE

Hydraulic & Pneumatic Manifolds



Heap & Partners Ltd

## Hydraulic & Pneumatic Manifolds

Following a significant investment, Heap & Partners Phase range of Distribution Manifolds have been specially designed to suit a comprehensive range of pneumatic and hydraulic applications. From our industry leading design department and machine shop, we also offer entirely bespoke manifold designs to meet our Clients' stringent specifications.

Our standard manifold stock range is with ¼" outlet connections, whilst our ½" range is made to order.



## Core Features of Phase Manifolds

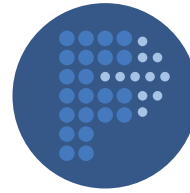

# PHASE

Hydraulic & Pneumatic Manifolds



### Applications

Phase manifold trees are designed to distribute gases or liquids from a compressor or pump to pneumatic ancillaries, or simply to redirect flow to multiple outlets.

### Design

The Phase manifolds are designed and manufactured in house by Heap & Partners. The standard range features lengths of up to 900mm, with a series of outlet configurations of up to 16 valves. All Stainless steel construction, Class 150 rated and with a selection of supply connections. We can also arrange design consultations for bespoke applications. Alternative materials are available to meet customer requirements.

### Engineering Capability

Heap & Partners have the capability to manage your product from start to finish. These include, but are not limited to:

- Comprehensive Engineering Product Design
- PMI Inspection of Raw and Finished Materials
- Industry Leading Machine Shop
- 3D Printing
- Laser Etching
- Robot Assisted Manufacture
- Climate Controlled Inspection Room
- Mitutoyo Co-ordinate Measuring Machine (CMM)
- New Assembly and Testing Facility
- Highly Skilled and Experienced Engineering Assembly Team

### Quality & Testing

Manufactured under SEP, all units are fully pressure tested and inspected prior to despatch. Our state-of-the-art test facilities, together with all the required documentation and certification, will give any user peace of mind, no matter how arduous the duty.



Heap &  
Partners Ltd



# Phase Manifold Engineering Capabilities

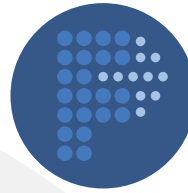

**PHASE**  
Hydraulic & Pneumatic Manifolds

1"n.b. #150 Raised Face Swivel Flange

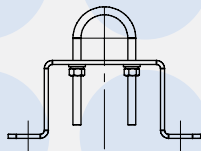
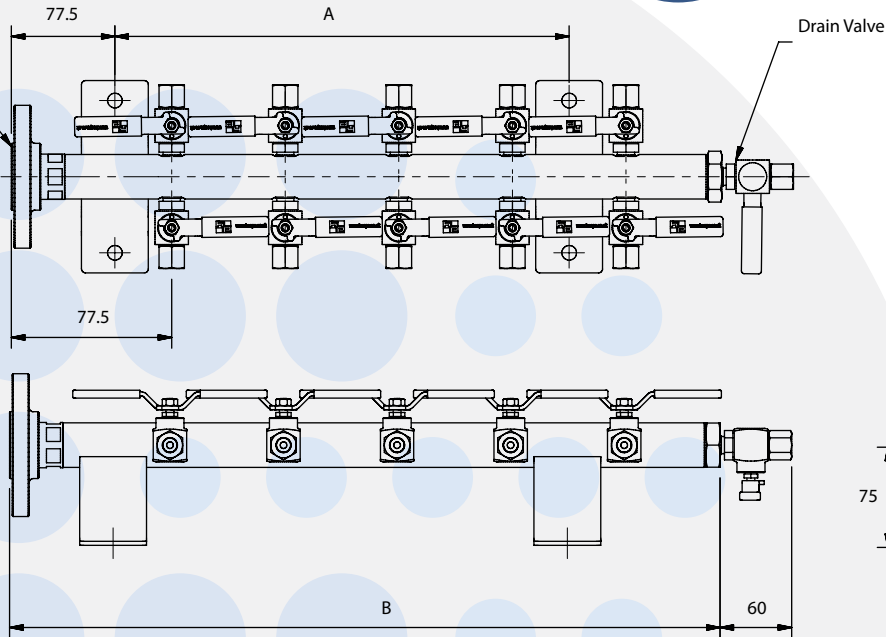

2 x Ø11 Mounting Holes

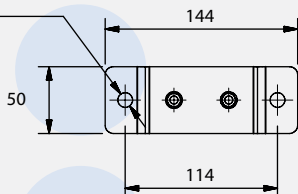

Bolt On Feet Details

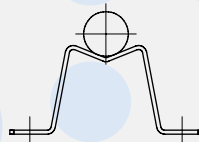

2 x Ø11 Mounting Holes

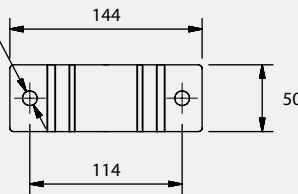

Weld On Feet Details

Variable Dimensions		
Outlet Qty	Weld On Feet Spacing 'A'	Manifold Length 'B' (Excluding drain)
4	85	277
6	170	362
8	255	447
10	340	532
12	425	617
14	510	702
16	595	787

## Phase Manifold Specification Range includes as standard:

<b>Applications Include:</b>	Gas, water, acids, alkalis & salt solutions
<b>Supply Connections:</b>	1" threaded BSPP, BSPT, NPT, Welded Flange and Captive Flange
<b>Branch Connections:</b>	¼" & ½" threaded BSPT, NPT or Twin Ferrule options
<b>Outlet Connections:</b>	Plugged or threaded valve
<b>Valves:</b>	¼" turn PTFE seated ball valves
<b>Pressure Range:</b>	Pressure class 150
<b>Temperature Range:</b>	-10°C to +40°C
<b>Number of Branches:</b>	4, 6, 8, 10, 12, 14 and 16 as standard. Bespoke designs may include more if necessary
<b>Materials:</b>	316 Stainless Steel
<b>Mounting Options:</b>	Bolt on feet, Welded feet or no mounting (standard)
<b>Drain:</b>	Drain size will be based upon manifold bore
<b>Stocking Policy:</b>	All stock will be based upon ¼" branch connections. All ½" manifolds are made to order
<b>Bespoke Designs:</b>	We are very flexible within our design capabilities so please do not hesitate to ask for any adjustments

